

# CREEK RISE

## FLOOR PLANS TOWER 1



# CREEK RISE



## 2 BEDROOM WITH BALCONY

TOWER 1  
UNIT 01 | LEVELS 2-16

Suite Area 1073.05 Sq.ft. / 99.69 Sq.m.  
Balcony Area 172.65 Sq.ft. / 16.04 Sq.m.  
Total Area 1245.71 Sq.ft. / 115.73 Sq.m.



### FLOOR PLAN

1. All dimensions are in imperial and metric, and measured from finish to finish excluding construction tolerances. 2. All materials, dimensions, and drawings are approximate only. 3. Information is subject to change without notice, at developer's absolute discretion. 4. Actual area may vary from the stated area. 5. Drawings not to scale. 6. All images used are for illustrative purposes only and do not represent the actual size, features, specifications, fittings, and furnishings. 7. The developer reserves the right to make revisions / alterations, at it's absolute discretion, without any liability whatsoever.



# CREEK RISE



## 2 BEDROOM WITH BALCONY

TOWER 1  
UNIT 02 | LEVELS 2-16

Suite Area 1035.06 Sq.ft. / 96.16 Sq.m.

Balcony Area 68.03 Sq.ft. / 6.32 Sq.m.

Total Area 1103.09 Sq.ft. / 102.48 Sq.m.

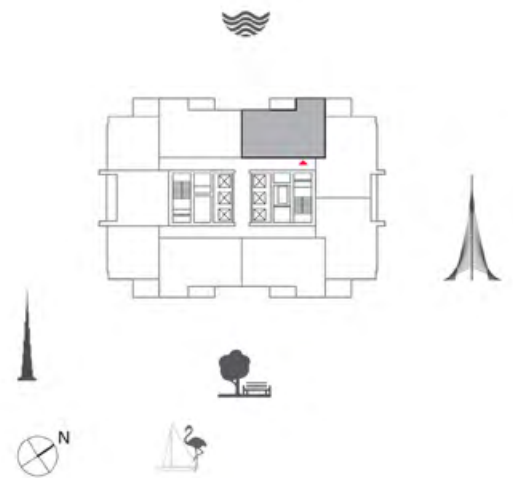

### FLOOR PLAN



1. All dimensions are in imperial and metric, and measured from finish to finish excluding construction tolerances. 2. All materials, dimensions, and drawings are approximate only. 3. Information is subject to change without notice, at developer's absolute discretion. 4. Actual area may vary from the stated area. 5. Drawings not to scale. 6. All images used are for illustrative purposes only and do not represent the actual size, features, specifications, fittings, and furnishings. 7. The developer reserves the right to make revisions / alterations, at it's absolute discretion, without any liability whatsoever.

# CREEK RISE

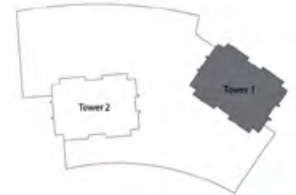

## 2 BEDROOM WITH BALCONY

TOWER 1  
UNIT 03 | LEVELS 2-16

Suite Area 1035.06 Sq.ft. / 96.16 Sq.m.

Balcony Area 68.03 Sq.ft. / 6.32 Sq.m.

Total Area 1103.09 Sq.ft. / 102.48 Sq.m.



### FLOOR PLAN



1. All dimensions are in imperial and metric, and measured from finish to finish excluding construction tolerances. 2. All materials, dimensions, and drawings are approximate only. 3. Information is subject to change without notice, at developer's absolute discretion. 4. Actual area may vary from the stated area. 5. Drawings not to scale. 6. All images used are for illustrative purposes only and do not represent the actual size, features, specifications, fittings, and furnishings. 7. The developer reserves the right to make revisions / alterations, at it's absolute discretion, without any liability whatsoever.

# CREEK RISE



## 1 BEDROOM WITH BALCONY

TOWER 1  
UNIT 04 | LEVELS 2-16

Suite Area 716.55 Sq.ft. / 66.57 Sq.m.

Balcony Area 103.33 Sq.ft. / 9.60 Sq.m.

Total Area 819.89 Sq.ft. / 76.17 Sq.m.



### FLOOR PLAN



1. All dimensions are in imperial and metric, and measured from finish to finish excluding construction tolerances. 2. All materials, dimensions, and drawings are approximate only. 3. Information is subject to change without notice, at developer's absolute discretion. 4. Actual area may vary from the stated area. 5. Drawings not to scale. 6. All images used are for illustrative purposes only and do not represent the actual size, features, specifications, fittings, and furnishings. 7. The developer reserves the right to make revisions / alterations, at its absolute discretion, without any liability whatsoever.

# CREEK RISE



## 1 BEDROOM WITH BALCONY

TOWER 1  
UNIT 05 | LEVELS 2-16

Suite Area 695.56 Sq.ft. / 64.62 Sq.m.

Balcony Area 134.98 Sq.ft. / 12.54 Sq.m.

Total Area 830.54 Sq.ft. / 77.16 Sq.m.

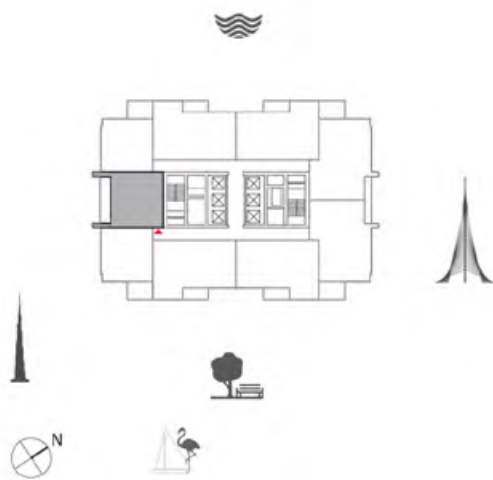

### FLOOR PLAN



1. All dimensions are in imperial and metric, and measured from finish to finish excluding construction tolerances. 2. All materials, dimensions, and drawings are approximate only. 3. Information is subject to change without notice, at developer's absolute discretion. 4. Actual area may vary from the stated area. 5. Drawings not to scale. 6. All images used are for illustrative purposes only and do not represent the actual size, features, specifications, fittings, and furnishings. 7. The developer reserves the right to make revisions / alterations, at it's absolute discretion, without any liability whatsoever.

# CREEK RISE



## 1 BEDROOM WITH BALCONY

TOWER 1  
UNIT 06 | LEVELS 2-16

Suite Area 681.68 Sq.ft. / 63.33 Sq.m.

Balcony Area 103.33 Sq.ft. / 9.60 Sq.m.

Total Area 785.01 Sq.ft. / 72.93 Sq.m.



### FLOOR PLAN



1. All dimensions are in imperial and metric, and measured from finish to finish excluding construction tolerances. 2. All materials, dimensions, and drawings are approximate only. 3. Information is subject to change without notice, at developer's absolute discretion. 4. Actual area may vary from the stated area. 5. Drawings not to scale. 6. All images used are for illustrative purposes only and do not represent the actual size, features, specifications, fittings, and furnishings. 7. The developer reserves the right to make revisions / alterations, at its absolute discretion, without any liability whatsoever.

# CREEK RISE

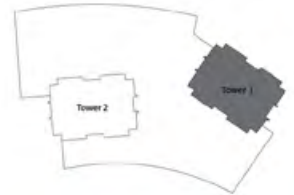

## 2 BEDROOM WITH BALCONY

TOWER 1  
UNIT 07 | LEVEL 2-16, UNIT 06 | LEVEL 18-36

Suite Area 1035.06 Sq.ft. / 96.16 Sq.m.

Balcony Area 68.03 Sq.ft. / 6.32 Sq.m.

Total Area 1103.09 Sq.ft. / 102.48 Sq.m.



### FLOOR PLAN



1. All dimensions are in imperial and metric, and measured from finish to finish excluding construction tolerances. 2. All materials, dimensions, and drawings are approximate only. 3. Information is subject to change without notice, at developer's absolute discretion. 4. Actual area may vary from the stated area. 5. Drawings not to scale. 6. All images used are for illustrative purposes only and do not represent the actual size, features, specifications, fittings, and furnishings. 7. The developer reserves the right to make revisions / alterations, at it's absolute discretion, without any liability whatsoever.



# CREEK RISE



## 2 BEDROOM WITH BALCONY

TOWER 1  
UNIT 08 | LEVELS 2-16, UNIT 07 | LEVELS 18-36

Suite Area 1035.06 Sq.ft. / 96.16 Sq.m.

Balcony Area 68.03 Sq.ft. / 6.32 Sq.m.

Total Area 1103.09 Sq.ft. / 102.48 Sq.m.



### FLOOR PLAN



1. All dimensions are in imperial and metric, and measured from finish to finish excluding construction tolerances. 2. All materials, dimensions, and drawings are approximate only. 3. Information is subject to change without notice, at developer's absolute discretion. 4. Actual area may vary from the stated area. 5. Drawings not to scale. 6. All images used are for illustrative purposes only and do not represent the actual size, features, specifications, fittings, and furnishings. 7. The developer reserves the right to make revisions / alterations, at it's absolute discretion, without any liability whatsoever.

# CREEK RISE

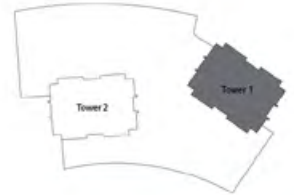

## 2 BEDROOM WITH BALCONY

TOWER 1  
UNIT 09 | LEVELS 2-16

Suite Area 1073.05 Sq.ft. / 99.69 Sq.m.

Balcony Area 172.65 Sq.ft. / 16.04 Sq.m.

Total Area 1245.71 Sq.ft. / 115.73 Sq.m.



### FLOOR PLAN

1. All dimensions are in imperial and metric, and measured from finish to finish excluding construction tolerances.
2. All materials, dimensions, and drawings are approximate only.
3. Information is subject to change without notice, at developer's absolute discretion.
4. Actual area may vary from the stated area.
5. Drawings not to scale.
6. All images used are for illustrative purposes only and do not represent the actual size, features, specifications, fittings, and furnishings.
7. The developer reserves the right to make revisions / alterations, at it's absolute discretion, without any liability whatsoever.



# CREEK RISE

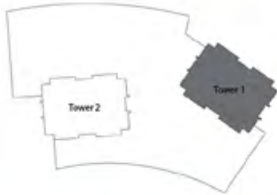

## 3 BEDROOM WITH BALCONY

TOWER 1  
UNIT 01 | LEVELS 18-36

Suite Area 1433.86 Sq.ft. / 133.21 Sq.m.

Balcony Area 208.82 Sq.ft. / 19.40 Sq.m.

Total Area 1642.68 Sq.ft. / 152.61 Sq.m.



### FLOOR PLAN

1. All dimensions are in imperial and metric, and measured from finish to finish excluding construction tolerances.
2. All materials, dimensions, and drawings are approximate only.
3. Information is subject to change without notice, at developer's absolute discretion.
4. Actual area may vary from the stated area.
5. Drawings not to scale.
6. All images used are for illustrative purposes only and do not represent the actual size, features, specifications, fittings, and furnishings.
7. The developer reserves the right to make revisions / alterations, at it's absolute discretion, without any liability whatsoever.



# CREEK RISE



## 1 BEDROOM WITH BALCONY

TOWER 1  
UNIT 02 | LEVELS 18-36

Suite Area 706.54 Sq.ft. / 65.64 Sq.m.

Balcony Area 68.03 Sq.ft. / 6.32 Sq.m.

Total Area 774.57 Sq.ft. / 71.96 Sq.m.

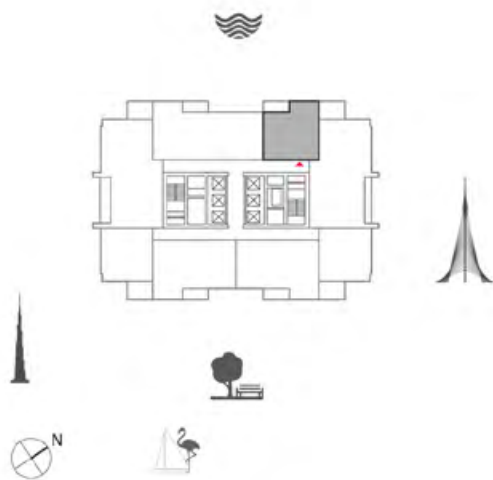

### FLOOR PLAN



1. All dimensions are in imperial and metric, and measured from finish to finish excluding construction tolerances. 2. All materials, dimensions, and drawings are approximate only. 3. Information is subject to change without notice, at developer's absolute discretion. 4. Actual area may vary from the stated area. 5. Drawings not to scale. 6. All images used are for illustrative purposes only and do not represent the actual size, features, specifications, fittings, and furnishings. 7. The developer reserves the right to make revisions / alterations, at it's absolute discretion, without any liability whatsoever.

# CREEK RISE



## 3 BEDROOM WITH BALCONY

TOWER 1  
UNIT 03 | LEVELS 18-36

Suite Area 1373.37 Sq.ft. / 127.59 Sq.m.

Balcony Area 68.03 Sq.ft. / 6.32 Sq.m.

Total Area 1441.40 Sq.ft. / 133.91 Sq.m.



### FLOOR PLAN



1. All dimensions are in imperial and metric, and measured from finish to finish excluding construction tolerances. 2. All materials, dimensions, and drawings are approximate only. 3. Information is subject to change without notice, at developer's absolute discretion. 4. Actual area may vary from the stated area. 5. Drawings not to scale. 6. All images used are for illustrative purposes only and do not represent the actual size, features, specifications, fittings, and furnishings. 7. The developer reserves the right to make revisions / alterations, at its absolute discretion, without any liability whatsoever.

# CREEK RISE



## 3 BEDROOM WITH BALCONY

TOWER 1  
UNIT 04 | LEVELS 18-36

Suite Area 1433.86 Sq.ft. / 133.21 Sq.m.

Balcony Area 208.82 Sq.ft. / 19.40 Sq.m.

Total Area 1642.68 Sq.ft. / 152.61 Sq.m.



### FLOOR PLAN

1. All dimensions are in imperial and metric, and measured from finish to finish excluding construction tolerances.
2. All materials, dimensions, and drawings are approximate only.
3. Information is subject to change without notice, at developer's absolute discretion.
4. Actual area may vary from the stated area.
5. Drawings not to scale.
6. All images used are for illustrative purposes only and do not represent the actual size, features, specifications, fittings, and furnishings.
7. The developer reserves the right to make revisions / alterations, at its absolute discretion, without any liability whatsoever.



# CREEK RISE



## 1 BEDROOM WITH BALCONY

TOWER 1  
UNIT 05 | LEVELS 18-36

Suite Area 716.55 Sq.ft. / 66.57 Sq.m.

Balcony Area 103.33 Sq.ft. / 9.60 Sq.m.

Total Area 819.89 Sq.ft. / 76.17 Sq.m.

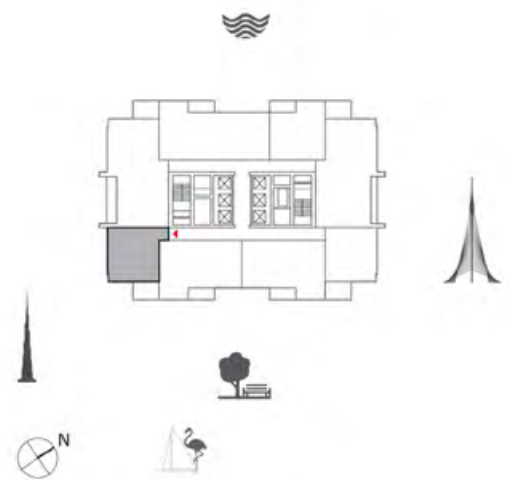

### FLOOR PLAN



1. All dimensions are in imperial and metric, and measured from finish to finish excluding construction tolerances. 2. All materials, dimensions, and drawings are approximate only. 3. Information is subject to change without notice, at developer's absolute discretion. 4. Actual area may vary from the stated area. 5. Drawings not to scale. 6. All images used are for illustrative purposes only and do not represent the actual size, features, specifications, fittings, and furnishings. 7. The developer reserves the right to make revisions / alterations, at it's absolute discretion, without any liability whatsoever.

# CREEK RISE



## 1 BEDROOM WITH BALCONY

TOWER 1  
UNIT 08 | LEVELS 18-36

Suite Area 716.55 Sq.ft. / 66.57 Sq.m.

Balcony Area 103.33 Sq.ft. / 9.60 Sq.m.

Total Area 819.89 Sq.ft. / 76.17 Sq.m.

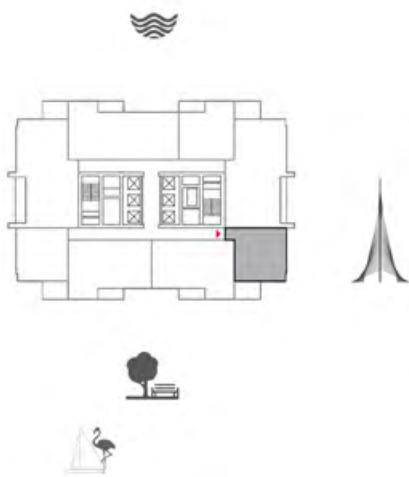

### FLOOR PLAN



1. All dimensions are in imperial and metric, and measured from finish to finish excluding construction tolerances. 2. All materials, dimensions, and drawings are approximate only. 3. Information is subject to change without notice, at developer's absolute discretion. 4. Actual area may vary from the stated area. 5. Drawings not to scale. 6. All images used are for illustrative purposes only and do not represent the actual size, features, specifications, fittings, and furnishings. 7. The developer reserves the right to make revisions / alterations, at it's absolute discretion, without any liability whatsoever.